

Technical sheet Filter boxes FD

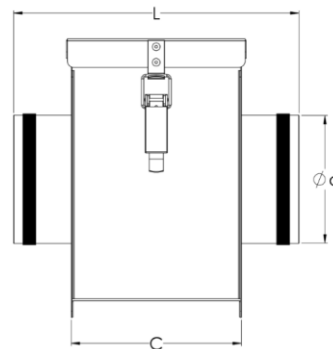
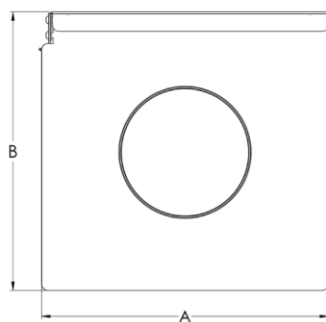

Product description

Filter boxes FD are used to clean supplied air. They are mounted into a system of circular air ducts. Completed with exchangeable FM-type G4 class panel filters. Maintenance cover is attached to the casing using one hinge and is easily removable. The products are made from hot-galvanised sheet metal. Equipped with rubber gaskets.

Products accordance with standards:

- EVS-EN 1506:2007 Ventilation for buildings - Sheet metal air ducts and fittings with circular cross-section - Dimensions
- EVS-EN 10346:2015 Continuously hot-dip coated steel flat products for cold forming - Technical delivery conditions

DIMENSIONS						
Type	A, mm	B, mm	C, mm	L, mm	Ød, mm	m, kg
FD100	223	215	131	220	100	1,5
FD125	223	215	131	220	125	1,5
FD160	223	215	131	220	160	1,4
FD200	268	257	131	220	200	1,7
FD250	317	306	131	244	250	2,3
FD315	367	357	131	244	315	2,7
FD400	472	461	131	244	400	3,9